

# SIGN LEGEND

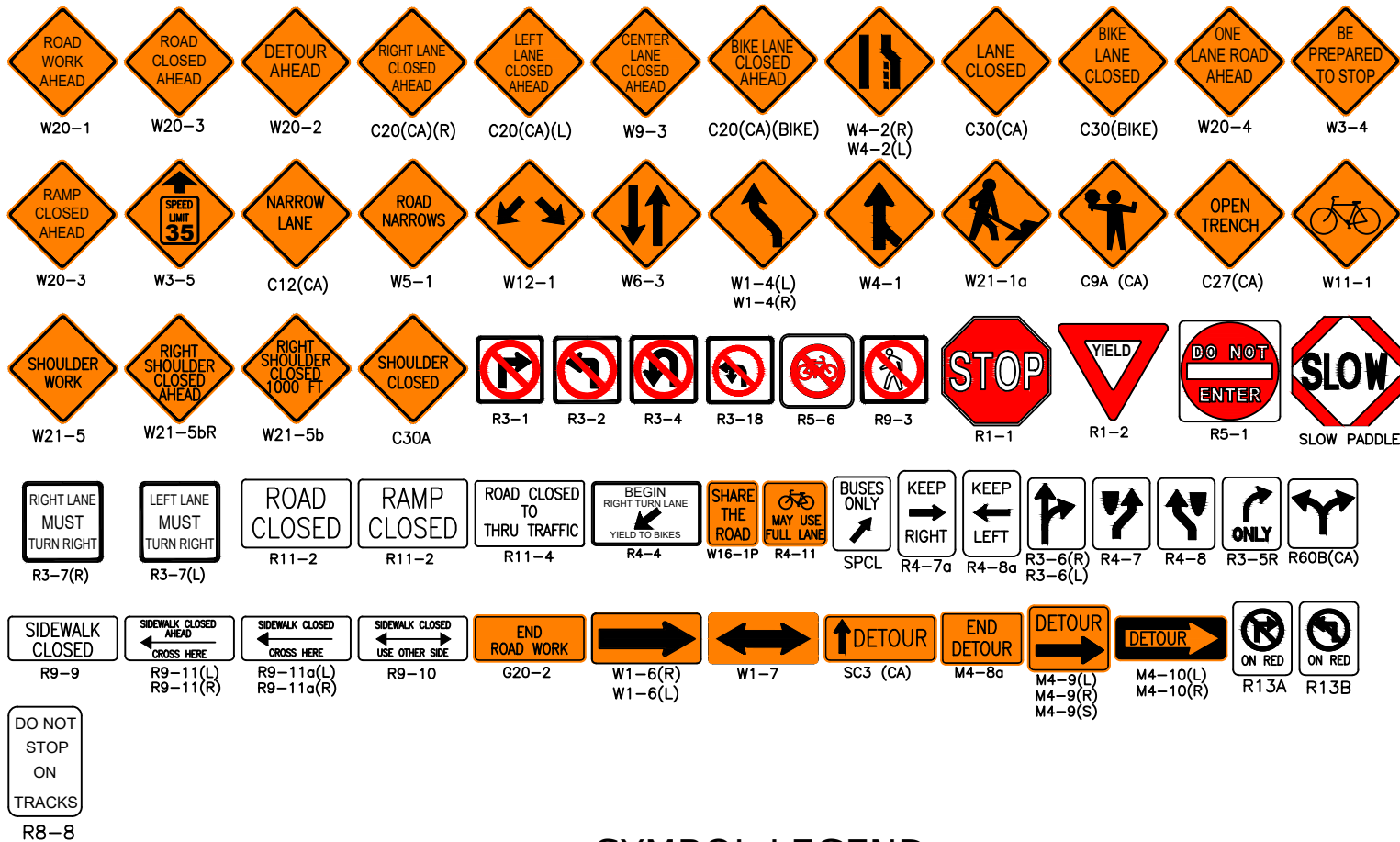

# SYMBOL LEGEND

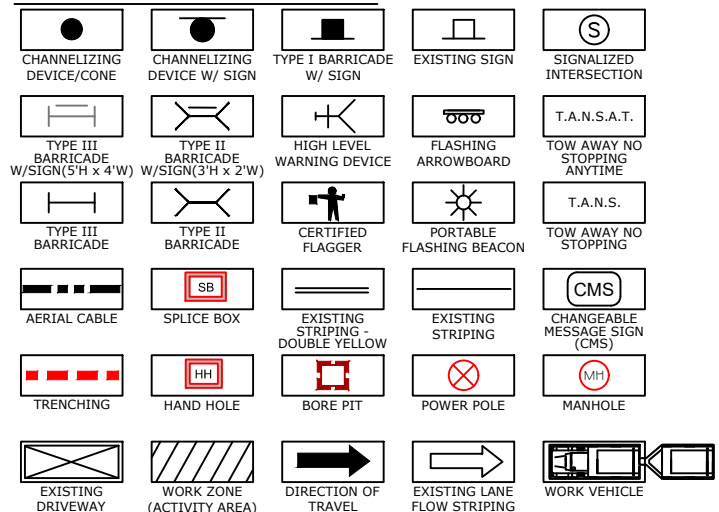

# GENERAL TRAFFIC CONTROL NOTES:

1. THE CONTRACTOR IS RESPONSIBLE FOR PROMPTLY RESTORING THE ROAD BACK TO SATISFACTORY CONDITION WHICH INCLUDES, BUT IS NOT LIMITED TO, PAVING, STRIPING, MARKINGS, SIGNAGE, AND LOOP DETECTION. ALL PLANS SHALL BE IN ACCORDANCE WITH 2014 CAMUTCD.
2. THE AGENCY RESERVES THE RIGHT TO OBSERVE THESE TRAFFIC CONTROL PLANS IN OPERATION AND TO MAKE CHANGES AS FIELD CONDITIONS WARRANT.
3. TRENCHES SHALL BE BACKFILLED OR STEEL-PLATED DURING NON-WORK HOURS. STEEL PLATES SHALL HAVE AN ASPHALT RAMP ON ALL EDGES, SECURELY SUPPORTED SO THEY WON'T ROCK AND A SIGN POSTED NEAR THE PLATES IDENTIFYING THE CONTRACTOR'S NAME AND 24 HOUR EMERGENCY TELEPHONE NUMBER. ALL DIRT, DUST, AND DEBRIS SHALL BE REMOVED FROM THE STREET AT THE END OF EACH DAY AND AT THE END OF THE JOB. THE STREET SHALL BE KEPT IN A DRIVABLE CONDITION AT ALL TIMES.
4. ANY WORK THAT CREATES AN UNDUE SAFETY RISK OR THAT CREATES SEVERE CONGESTION WILL BE SHUT DOWN BY THE AGENCY.
5. A COPY OF ALL TRAFFIC REQUIREMENTS AND TRAFFIC CONTROL PLANS ISSUED BY THE AGENCY MUST BE KEPT ON THE JOB SITE.
6. APPROVAL OF THIS PLAN DOES NOT CONSTITUTE AN OFFICIAL PERMIT. CONTACT THE AGENCY FOR INFORMATION ON OBTAINING A PERMIT.
7. ALL TRAVEL LANES WILL TYPICALLY BE A MINIMUM OF 12 FEET WIDE, 14 FEET IF ADJACENT TO BIKE LANES, UNLESS OTHERWISE SPECIFICALLY APPROVED BY THE AGENCY.
8. FLASHING ARROW BOARDS AS REQUIRED BY THE AGENCY.
9. WARNING (W) SERIES SIGNS USED IN WORK ZONES SHALL BE BLACK ON AN ORANGE BACKGROUND.
10. CONES AND PYLONS SHALL HAVE YELLOW REFLECTORIZED SLEEVES WHEN PLACED ALONG THE CENTERLINE AND WHITE REFLECTORIZED SLEEVES ALONG THE OUTSIDE SHOULDER.
11. IF PARKING IS ALLOWED IN THE ADVANCE WORKING AREA, ADVANCE WARNING SIGNS SHALL BE MOUNTED ON HIGH LEVEL DEVICES.
12. THE CONTRACTOR SHALL POST TOW-AWAY/NO PARKING SIGNS SEVENTY-TWO (72) HOURS IN ADVANCE, WITH DAY OF WEEK, DATE, AND WORK HOURS NOTED, AND SHALL BAG PARKING METERS (WHERE APPLICABLE).
13. OPEN CUT WORK SHALL BE DONE IN \_\_ PHASES.
14. WORKERS SHALL WEAR HARD HATS AND ORANGE VESTS AT ALL TIMES.
15. COUNTY TRANSIT DISTRICT SHALL BE NOTIFIED (5) WORKING DAYS PRIOR TO ANY WORK THAT AFFECTS BUS STOPS.
16. CONSTRUCTION SIGNS SHALL NOT OBSTRUCT SIGHT VISIBILITY AT DRIVEWAYS.
17. CONTRACTOR SHALL NOTIFY ALL LOCAL BUSINESS OWNERS/OCCUPANTS 72 HOURS IN ADVANCE PRIOR TO ANY CONSTRUCTION ADJACENT TO BUSINESSES.

JOB LOCATION: **945 MCHENRY AVE.**

WORK HOURS: FROM: TO:

BEGIN CROSS STREET: **MAGNOLIA AVE.** END CROSS STREET: **KIMBLE ST.**

PERMIT NUMBER: THOMAS GUIDE:

SCOPE OF WORK: **MH ACCESS, TRENCHING & NEW SB, PFP CABINET PL.**

START DATE: END DATE:

POSTED SPEED LIMIT	APPROACH SPEED	TAPER LENGTH	CONE SPACING	SIGN SPACING
VARIABLES	VARIABLES	VARIABLES	VARIABLES	VARIABLES

TRAFFIC CONTROL PLAN DISCLOSURE:

NOTHING CONTAINED ON THIS DRAWING SHALL PREVENT LOCAL JURISDICTIONS FROM MODIFYING, CHANGING, OR ADOPTING NEW SPECIFICATIONS DEEMED NECESSARY.

CRITERIA FOR POSITION, LOCATION, AND USE OF TRAFFIC CONTROL DEVICES IS SOLELY FOR THE PURPOSE OF GUIDANCE TO ASSIST IN THE SET UP OF THE TRAFFIC CONTROL PLANS.

APPROVAL OF THIS PLAN DOES NOT CONSTITUTE AN OFFICIAL PERMIT. CONTACT THE AGENCY FOR INFORMATION ON OBTAINING A PERMIT.

-TABLE 6C-1 2014 CALIFORNIA MUTCD- RECOMMENDED ADVANCE WARNING SIGN SPACING-

ROAD TYPE	DISTANCE BETWEEN SIGNS**		
	A	B	C
URBAN - 25 MPH OR LESS***	100 FEET	100 FEET	100 FEET
URBAN - MORE THAN 25 MPH TO 40 MPH***	250 FEET	250 FEET	250 FEET
URBAN - MORE THAN 40 MPH***	350 FEET	350 FEET	350 FEET
RURAL	500 FEET	500 FEET	500 FEET
EXPRESSWAY/FREEWAY	1,000 FEET	1,500 FEET	2,640 FEET

\*\* THE COLUMN HEADING A, B, AND C ARE THE DIMENSIONS SHOWN IN FIGURES 6H-1 THROUGH 6H-46. THE A DIMENSION IS THE DISTANCE FROM THE TRANSITION OR POINT OF RESTRICTION TO THE FIRST SIGN. THE B DIMENSION IS THE DISTANCE BETWEEN THE FIRST AND SECOND SIGNS. THE C DIMENSION IS THE DISTANCE BETWEEN THE SECOND AND THIRD SIGN. (THE "FIRST SIGN" IS THE SIGN IN A THREE-SIGN SERIES THAT IS CLOSEST TO TTC ZONE. THE "THIRD SIGN" IS THE SIGN THAT IS FURTHEST UPSTREAM FROM THE TTC ZONE.)

\*\*\* POSTED SPEED LIMIT, OFF-PEAK 85TH-PERCENTILE SPEED PRIOR TO WORK STARTING, OR OTHER ANTICIPATED OPERATING SPEED IN MPH

-TABLE 6C-2 2014 CALIFORNIA MUTCD- STOPPING SIGHT DISTANCE AS A FUNCTION OF SPEED ON LEVEL ROADS- (USED AS SUGGESTED LONGITUDINAL BUFFER SPACE LENGTH OR LOCATION FOR FLAGGER STATION)

SPEED* (MPH)	DISTANCE (FT)
20	115
25	155
30	200
35	250
40	305
45	360
50	425
55	495
60	570
65	645
70	730
75	820

\* POSTED SPEED, OFF-PEAK 85TH-PERCENTILE SPEED PRIOR TO WORK STARTING OR THE ANTICIPATED OPERATING SPEED IN MPH

-TABLE 6C-3 2014 CALIFORNIA MUTCD- TAPER LENGTH CRITERIA FOR TEMPORARY TRAFFIC CONTROL ZONE-

TYPE OF TAPER	TAPER LENGTH (L)*
MERGING TAPER	AT LEAST L
SHIFTING TAPER	AT LEAST 0.5 L
SHOULDER TAPER	AT LEAST 0.33 L
ONE LANE, TWO-WAY TRAFFIC TAPER	SOFT MINIMUM, 100FT MAXIMUM
DOWNSTREAM TAPER	SOFT MINIMUM, 100FT MAXIMUM

-TABLE 6C-4 2014 CALIFORNIA MUTCD- FORMULAS FOR DETERMINING TAPER LENGTH-

SPEED LIMIT (S)	TAPER LENGTH (L)
40 MPH OR LESS	$L = \frac{WS}{50}$
45 MPH OR MORE	$L = WS$

WHERE: L= TAPER LENGTH IN METERS (FEET)  
 W= WIDTH OF OFFSET IN METERS (FEET)  
 S= POSTED SPEED LIMIT, OR OFF-PEAK 85TH-PERCENTILE SPEED PRIOR TO WORK STARTING, OR THE ANTICIPATED OPERATING SPEED IN KM/H (MPH)

## CITY NAME: MODESTO

# TRAFFIC CONTROL PLAN

JOB NUMBER **A02EMZB**  
 SCALE: N/A  
 PAGE: 1 OF 4

PLANS ACCEPTED BY: \_\_\_\_\_ DATE \_\_\_\_\_

R.C.E. \_\_\_\_\_ EXP. DATE \_\_\_\_\_

PLANS PREPARED BY: **amdocs**

NAME: **HEENA**

DATE: **4/02/25** ISSUE: **0**



**945 MCHENRY AVE.  
W FAIRMONT AVE. & DOUGLAS AVE.  
NEW SB #945, PFP CABINET PL. & TRENCHING  
WORK AREA 1 OF 2**



ISSUE	DATE
0	4/02/25

**PEDESTRIAN CONTROL NOTES:**

A DEDICATED INDIVIDUAL WILL BE ASSIGNED THE RESPONSIBILITY OF ESCORTING PEDESTRIANS THROUGH THE WORK AREA IN ACCORDANCE WITH THREE MAJOR CONSIDERATIONS:

1. PEDESTRIANS SHOULD NOT BE LED INTO DIRECT CONFLICT WITH WORK SITE VEHICLES, EQUIPMENT OR OPERATIONS
2. PEDESTRIANS SHOULD NOT BE LED INTO DIRECT CONFLICT WITH MAINLINE TRAFFIC MOVING THROUGH OR AROUND THE WORK SITE.
3. PEDESTRIANS SHOULD BE PROVIDED WITH A REASONABLY SAFE, CONVENIENT AND ACCESSIBLE PATH THAT REPLICATES AS NEARLY AS PRACTICAL THE MOST DESIRABLE CHARACTERISTICS OF THE EXISTING SIDEWALK OR FOOTPATH

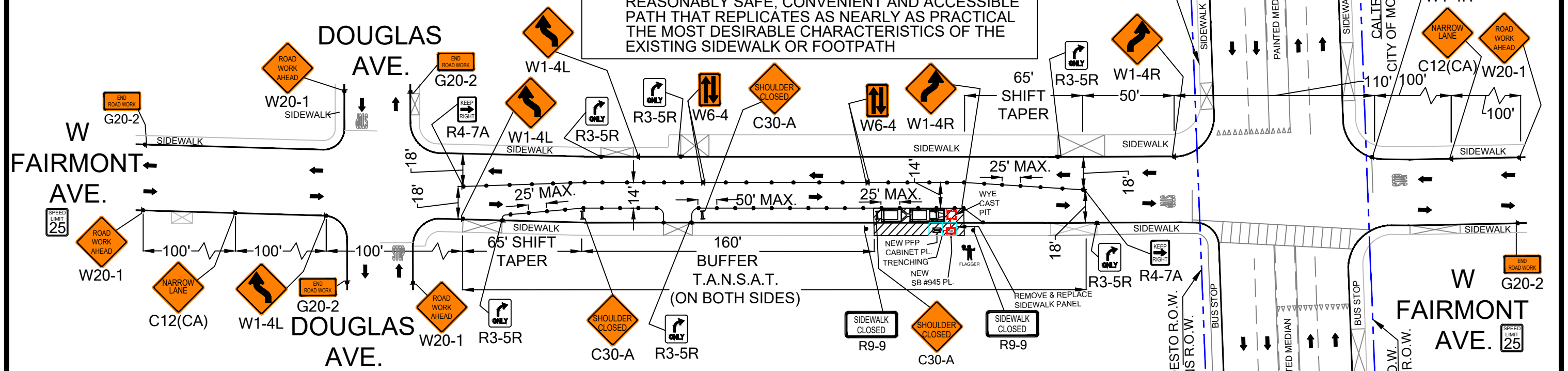

PLACE AT THE S/W CORNER OF W FAIRMONT AVE. & MCHENRY AVE.

ACCESS TO DRIVEWAYS MUST BE MAINTAINED AT ALL TIMES.

FLAGGER TO ASSIST PEDESTRIANS THROUGH WORK AREA (SEE PED NOTES)

CONTACT PROPERTY OWNER(S) 72 HOURS PRIOR TO START OF WORK.

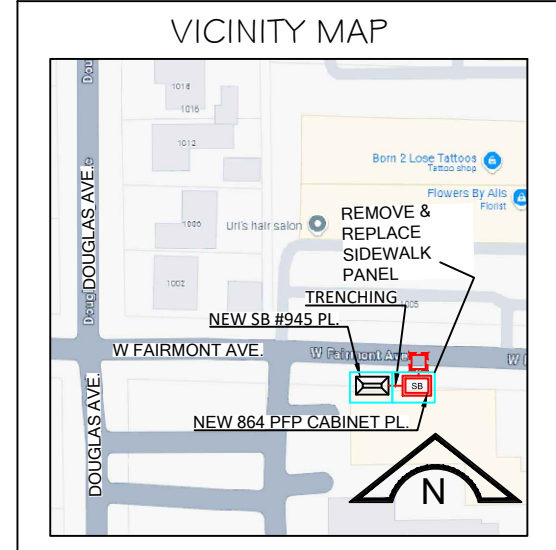

**LEGEND:**

	TYPE III BARRICADE W/SIGN (5'H x 4'W)		HIGH LEVEL WARNING DEVICE WITH SIGN (FLAGTREE)
	TYPE II BARRICADE W/O SIGN (3'H x 2'W)		FLAGGER
	28"(11cm)TRAFFIC CONES W/13"(5cm) REFLECTIVE SLEEVE FOR DAY/NIGHT USE OR DELINEATORS IF DAY USE ONLY		EXISTING DRIVEWAY
	TRAFFIC CONE WITH CLIP ON SIGN		TANSAT TOW AWAY NO STOPPING ANY TIME
	PROPOSED SIGN AND POST		WORK ZONE LIMITS
	SIGNALIZED INTERSECTION		DIRECTION OF TRAFFIC
	FLASHING ARROWBOARD		ETW EDGE OF TRAVELED WAY / FOG LINE
			FOC FACE OF CURB
			EOP EDGE OF PAVEMENT

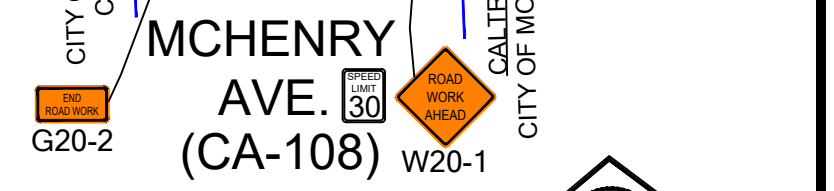

CONST ARC	COMP
GEO/CO	UG-56
EXCH.	MDSTCA02
ENGR.	JEFFREY K HENNING TEL. (916) 213-0865
ENGR ARC	VOKDLEE00
TYPE OF CONST.	TCP
RO/EST. NO.	A02EMZB
DWG.	2 OF 4
SCALE	1"= 50'

946 MCHENRY AVE.  
MCHENRY AVE. & E FAIRMONT AVE.  
MH #202 ACCESS  
WORK AREA 2 OF 2



ISSUE	DATE
0	4/02/25

MATCHLINE-A  
SEE DWG #4 OF DWG #4

ACCESS TO DRIVEWAYS MUST BE MAINTAINED AT ALL TIMES.

CONTACT PROPERTY OWNER(S) 72 HOURS PRIOR TO START OF WORK.

ALL TRAFFIC DEVICES WITHIN CALTRANS RIGHT OF WAY SHALL BE APPROVED BY CALTRANS

CONTACT TRANSIT AUTHORITY 3 DAYS PRIOR TO START OF WORK FOR TEMPORARY RELOCATION OF BUS STOP.

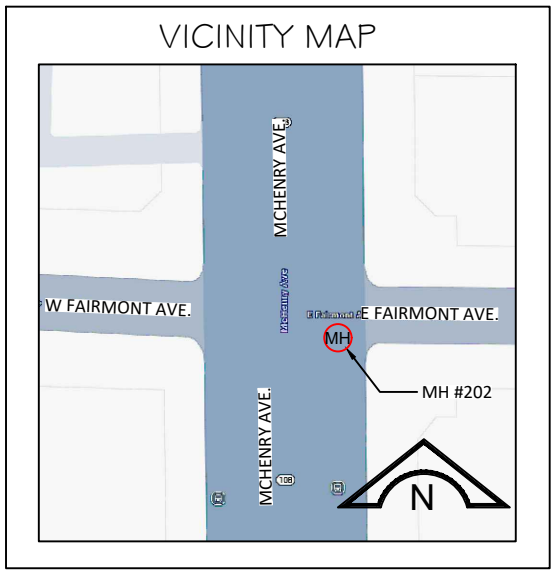
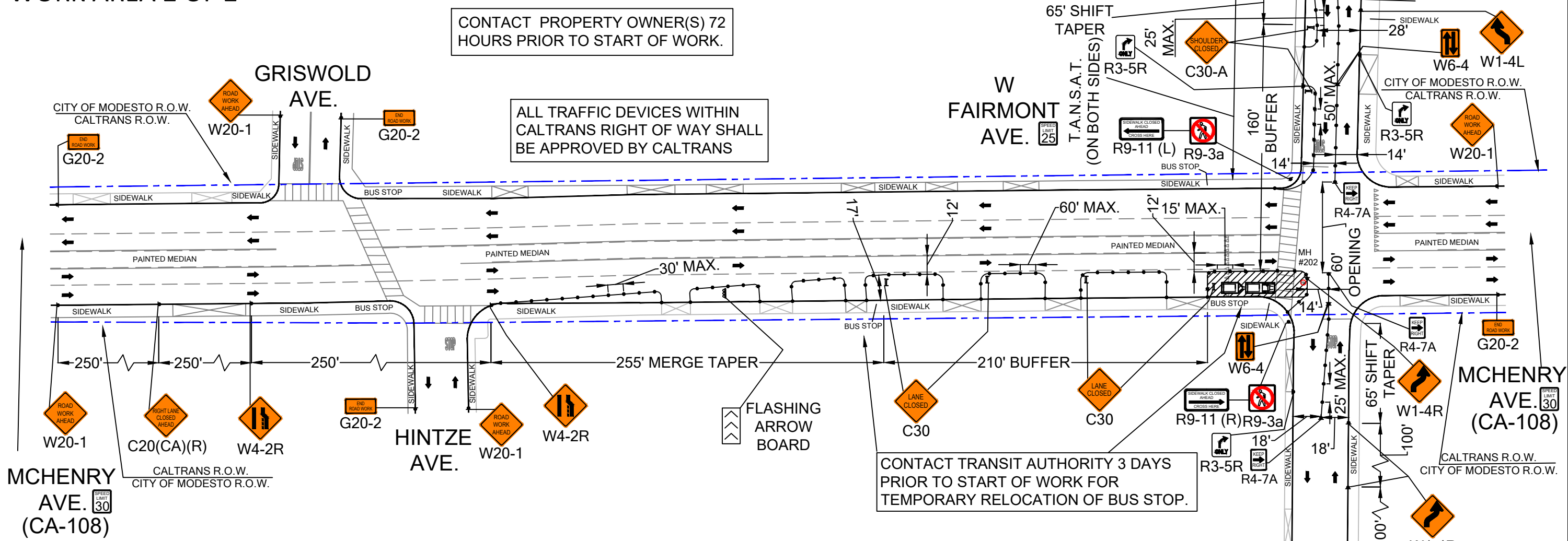

**LEGEND:**

	TYPE III BARRICADE W/SIGN (5'H x 4'W)		HIGH LEVEL WARNING DEVICE WITH SIGN (FLAGTREE)
	TYPE II BARRICADE W/O SIGN (3'H x 2'W)		FLAGGER
	28"(11cm)TRAFFIC CONES W/13"(5cm) REFLECTIVE SLEEVE FOR DAY/NIGHT USE OR DELINEATORS IF DAY USE ONLY		EXISTING DRIVEWAY
	TRAFFIC CONE WITH CLIP ON SIGN		TANSAT TOW AWAY NO STOPPING ANY TIME
	PROPOSED SIGN AND POST		WORK ZONE LIMITS
	SIGNALIZED INTERSECTION		DIRECTION OF TRAFFIC
	FLASHING ARROWBOARD		ETW EDGE OF TRAVELED WAY / FOG LINE
			FOC FACE OF CURB
			EOP EDGE OF PAVEMENT

CONST ARC	COMP
GEO/CO	UG-56
EXCH.	MDSTCA02
ENGR	JEFFREY K HENNING TEL. (916) 213-0865
ENGR ARC	VOKDLEE00
TYPE OF CONST.	TCP
RO/EST. NO.	A02EMZB
DWG.	3 OF 4
SCALE	1"= 60'

946 MCHENRY AVE.  
MCHENRY AVE. & E FAIRMONT AVE.  
MH #202 ACCESS  
WORK AREA 2 OF 2



ISSUE	DATE
0	4/02/25

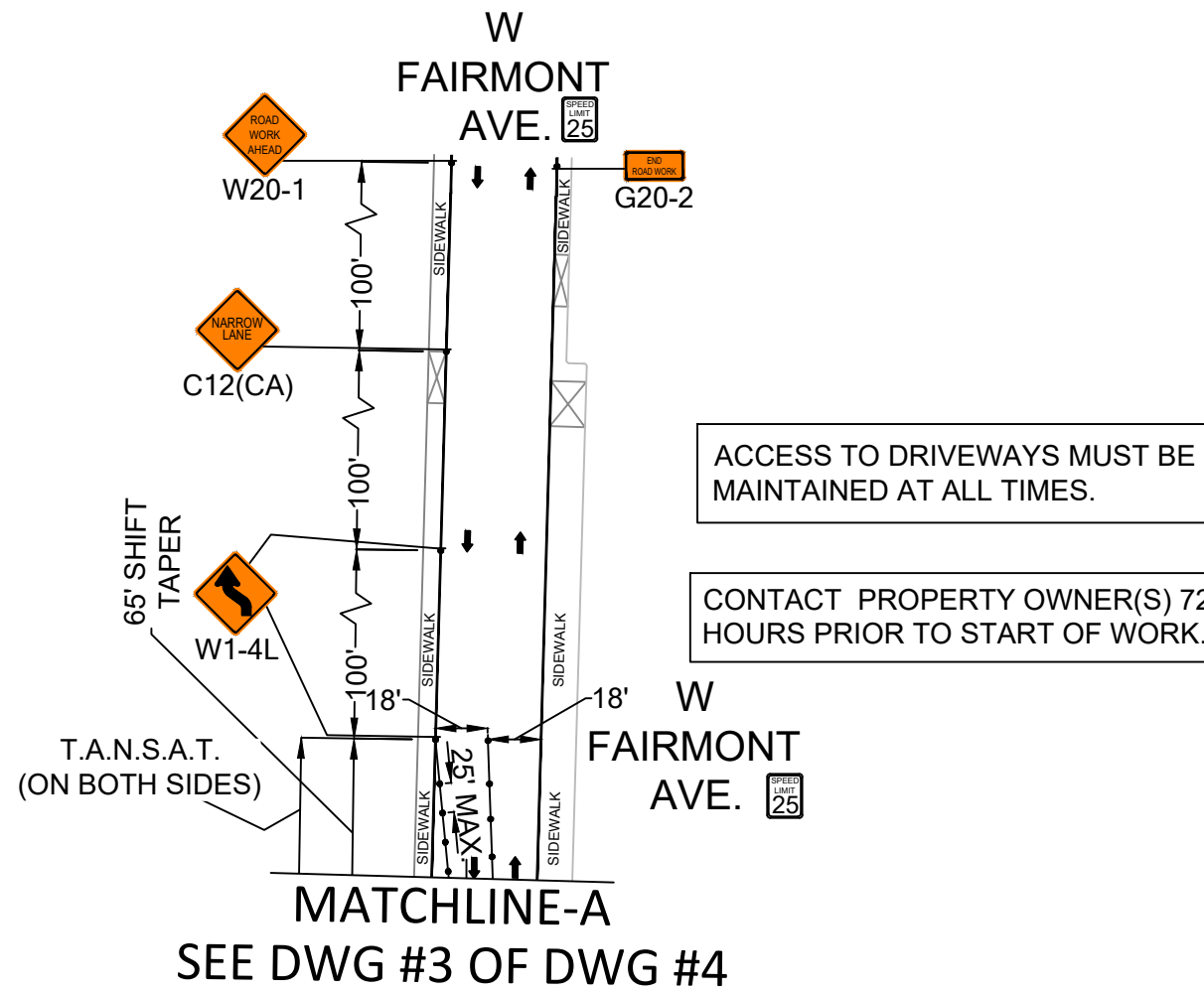

LEGEND:

	TYPE III BARRICADE W/SIGN (5'H x 4'W)		HIGH LEVEL WARNING DEVICE WITH SIGN (FLAGTREE)
	TYPE II BARRICADE W/O SIGN (3'H x 2'W)		FLAGGER
	28"(11cm)TRAFFIC CONES W/13"(5cm) REFLECTIVE SLEEVE FOR DAY/NIGHT USE OR DELINEATORS IF DAY USE ONLY		EXISTING DRIVEWAY
	TRAFFIC CONE WITH CLIP ON SIGN		TANSAT TOW AWAY NO STOPPING ANY TIME
	PROPOSED SIGN AND POST		WORK ZONE LIMITS
	SIGNALIZED INTERSECTION		DIRECTION OF TRAFFIC
	FLASHING ARROWBOARD		ETW EDGE OF TRAVELED WAY / FOG LINE
			FOC FACE OF CURB
			EOP EDGE OF PAVEMENT

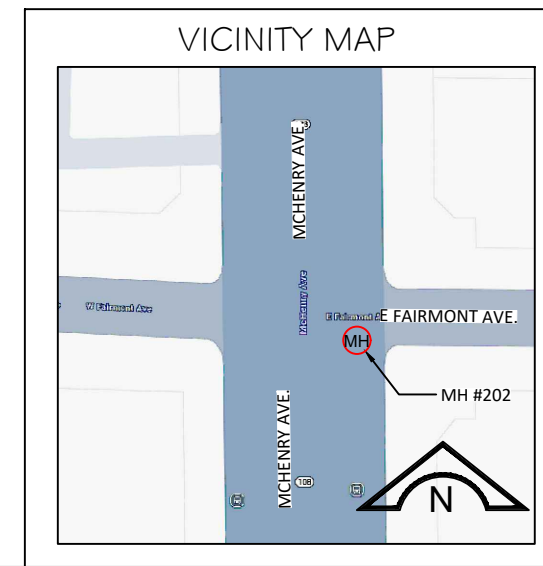

CONST ARC	_____	COMP	_____
GEO/CO	UG-56		
EXCH.	MDSTCA02		
ENGR.	JEFFREY K HENNING TEL. (916) 213-0865		
ENGR ARC	VOKDLEE00		
TYPE OF CONST.	TCP		
RO/EST. NO.	A02EMZB	SCALE	1"= 60'
DWG.	4	OF	4 P504