

KEY NOTES:

- (A) SOLAR MODULES
- (B) AC COMBINER
- (C) AC DISCONNECT(S)
- (D) UTILITY METER SOCKET
- (E) MAIN SERVICE PANEL
- (F) FENCE
- (G) 3' FIRE ACCESS PATHWAY

NOTE:
GATES/FENCES SHALL
REMAIN UNLOCKED.

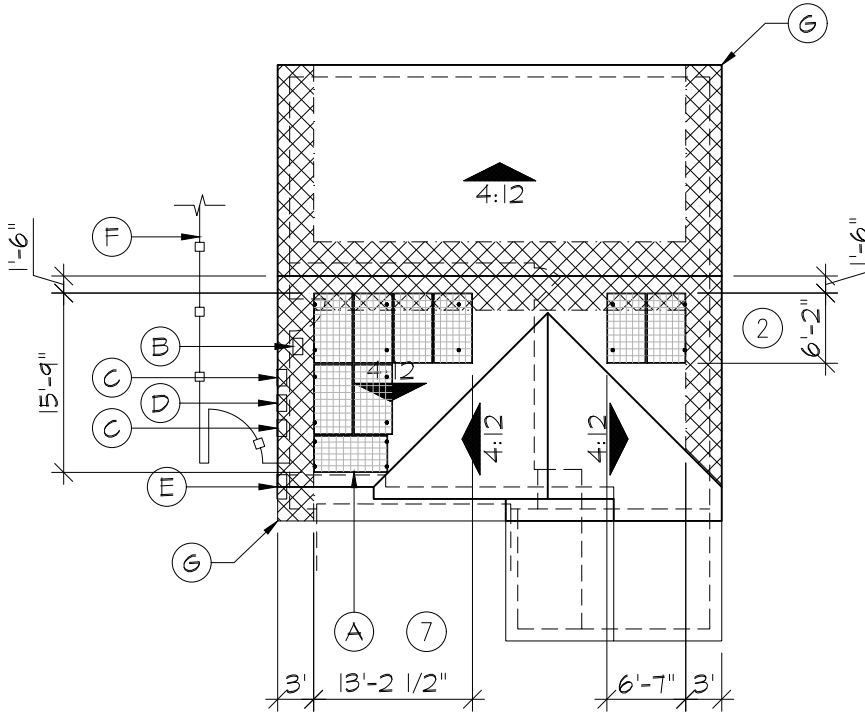

MICRO INVERTER LABELS:

- | | | | |
|---|--|---|--|
| 1 | | 6 | |
| 2 | | 7 | |
| 3 | | 8 | |
| 4 | | 9 | |
| 5 | | | |

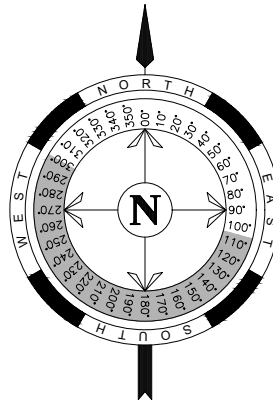

BUILDER: KB HOME	BUILDER ADDRESS: 4830 BUSINESS CENTER DR. SUITE 150, FAIRFIELD, CA 94534	PHOTOVOLTAIC SOLAR MODULE MODEL: QCELLS G.PEAK DUO BLK ML-G10+ 415	ARRAY SIZE: 3.74KW
PROJECT: AUTUMNWOOD	PROJECT ADDRESS: 2637 SALVATORE WAY, MODESTO, CA 95357	MODULE RATING: 415W	NUMBER OF MODULES: 9
		AZIMUTH: 180°	ROOF PITCH: 4:12
		DRAWN BY: MH	MOUNTING HEIGHT: 2-STORY
		DATE: 2/23/2026	PLAN: PHASE 6
		28	2069A

